

PCM-2300MR

MR4A16B, MRAM, 4 MB, mPCIe

NEW

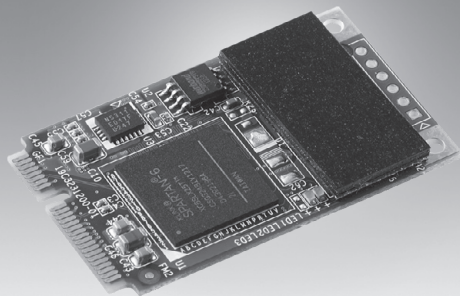

Features

- Meets Advantech iDoor technology standard
- PCI Express® Mini card specification revision 1.2 compliant
- Data always non-volatile for >20-year at temperature
- Read / Write memory speed 6 MB/Sec
- 4MB MRAM Storage
- I/O address automatically assigned by PCIe plug & play
- Supports Windows and Linux platform

Introduction

iDoor utilizing mini PCIe format allowing customers the flexibility for I/O and function expansion. The iDoor modules include expansion of wireless communication, industrial fieldbus, I/O and peripherals.

Specifications

General

- **Bus Type** PCI Express Mini Card Revision 1.2
- **Certification** CE, FCC class A
- **Dimensions** Module: 51 x 30 x 12.4 mm (2" x 1.18" x 0.49")
- **Power Consumption** Typical : +3.3 V @ 150 mA

Memory

- **Memory Everspin** MR4A16B
- **Size** 4 MB
- **Read/Write Speed** 6 MB/sec

Software

- **Driver** Win10, Ubuntu 18.04/20.04

Environment

- **Humidity (Operating)** 5-95% RH, non-condensing
- **Operating Temperature** -20 ~ 60°C (-4 ~ 140°F)
- **Storage Temperature** -40 ~ 85°C (-40 ~ 185°F)
- **Maximum magnetic field immunity during write** 8000 A/m
- **Maximum magnetic field during reading or standby** 8000 A/m

Dimensions

Module
PCM-2300MR

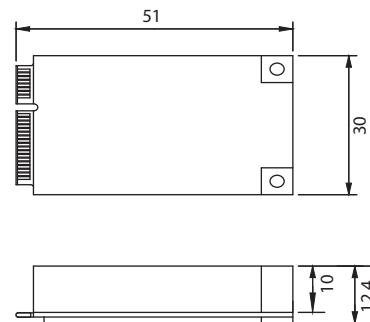

Ordering Information

- **PCM-2300MR-BE** MR4A16B, MRAM, 4MB